

**RUOTE PER TRANSPALLETTES - PALLET WHEELS - GABELHUBWAGEN-LENKRÄDER
ROUES POUR TRANSPALETTES - RUEDAS PARA TRANSPALETAS**

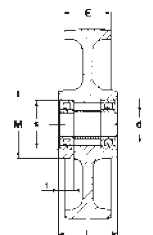

		ALLUMINIO + GOMMA ELASTICA ALUMINIUM + ELASTIC RUBBER ALUMINIUM + ELASTIK VOLLGUMMI ALUMINIUM + CAOUTCHOUC ELASTIQUE ALUMINIO + GOMA ELASTICA				POLIAMMIDE 6 + GOMMA ELASTICA POLYAMIDE 6 + ELASTIC RUBBER POLYAMID 6 + ELASTIK VOLLGUMMI POLYAMIDE 6 + CAOUTCHOUC ELASTIQUE POLIAMIDA 6 + GOMA ELASTICA				POLIAMMIDE 6 POLYAMIDE 6 POLYAMID 6 POLYAMIDE 6 POLIAMIDA 6			
	D	180	180	200	200	180	180	200	200	175	175	200	200
	E	50	50	50	50	50	50	50	50	50	50	50	50
Art. N.		2007cc	2008cc	2009cc	2010cc	30032Bcc▲	30033Bcc▲	30040Bcc▲	30041Bcc▲	4008cc▲	4005cc▲	4007cc▲	4006cc▲
	X	140	140	140	140	140	140	140	140	-	-	-	-
	d	20	25	20	25	20	25	20	25	20	25	20	25
	S	47	47	47	47	47	47	47	47	47	52	47	52
	t	17	17	17	17	17	17	17	17	17	17	17	17
	V	54	50	54	50	54	50	54	50	54	56	54	56
	L	60	60	60	60	60	60	60	60	60	60	60	60
	M	55	55	55	55	63	63	63	63	69	69	63	71
	Kg.	350	350	450	450	350	350	400	400	500	500	600	600

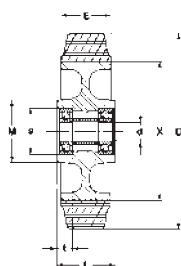
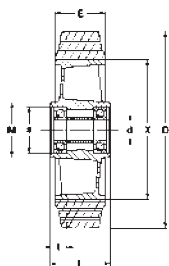
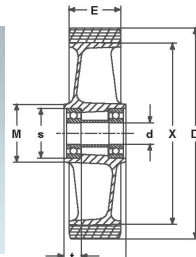
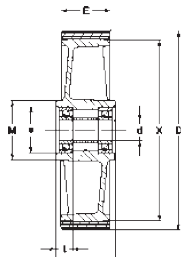
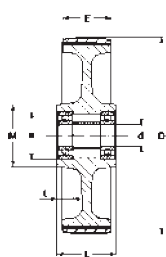

		POLIAMMIDE 6 + POLIURETANO AD INIEZIONE POLYAMIDE 6 + INJECTED POLYURETHANE POLYAMID 6 + POLYURETHAN GESPRITZT POLYAMIDE 6 + POLYURETHANE INJECTE POLIAMIDA 6 + POLIURETANO DE INYECCION		ALLUMINIO + POLIURETANO COLATO ALUMINIUM + CAST POLYURETHANE ALUMINIUM + GUSS-POLYURETHAN ALUMINIUM + POLYURETHANE COULE ALUMINIO + POLIURETANO COLADO			ALLUMINIO + POLIURETANO COLATO, DUREZZA 87 Sh.A ALUMINIUM + CAST POLYURETHANE, HARDNESS 87 Sh.A ALUMINIUM + GUSS-POLYURETHAN, HARTE 87 Sh.A ALUMINIUM + POLYURETHANE COULE, DURETE 87 Sh.A ALUMINIO + POLIURETANO COLADO, DUREZA 87 Sh.A	
	D	200	200	180	200	200	200	200
	E	50	50	50	50	50	50	50
Art. N.		9024cc▲	9025cc▲	8027cc	8032cc	8034cc	8032Bcc	8033Bcc
	X	-	-	140	184	184	170	170
	d	20	25	20	20	25	20	25
	S	47	47	47	47	52	47	47
	t	17	17	17	17	17	17	17
	V	54	50	54	54	56	54	50
	L	60	60	60	60	60	60	60
	M	62	62	55	56	60	55	55
	Kg.	550	550	700	800	800	700	700

FRENO PER TRANSPALLETTES IN KIT - BRAKING KIT FOR HAND PALLET TRUCKS BREMSEN-KIT FÜR GABELHUBWAGEN - FREIN POUR TRANSPALLETTES EN KIT FRENO PARA TRANSPALETAS EN KIT



	POLIURETANO COLATO 87 Sh.A CAST POLYURETHANE 87 Sh.A GUSS-POLYURETHAN 87 Sh.A POLYURETHANE COULE 87 Sh.A POLIURETANO COLADO 87 Sh.A	POLIURETANO COLATO 95 Sh.A CAST POLYURETHANE 95 Sh.A GUSS-POLYURETHAN 95 Sh.A POLYURETHANE COULE 95 Sh.A POLIURETANO COLADO 95 Sh.A	GOMMA ELASTICA ELASTIC RUBBER ELASTIK VOLLGUMMI CAOUTCHOUC ELASTIQUE GOMA ELÁSTICA	
D	180	200	180	200
E	50	50	50	50
Art. N.	7996B	7997	2996	2997
B	204	204	204	204
A	59	59	59	59
F	8	8	8	8
G	25	25	25	25
Kg.	1500	1600	700	900

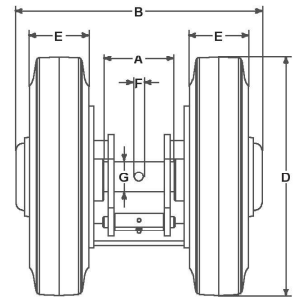

SOLO RUOTA - WHEEL ONLY - EINZELRAD - ROUE SEULE - RUEDA SOLA

Art. N.	7994Bcc	7995cc	2994cc	2995cc
d	20	20	20	20
R	115	115	115	115
Kg.	750	800	350	450

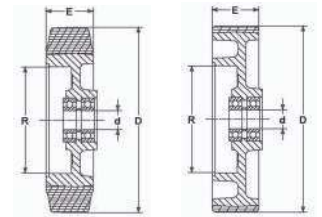

LEVA FRENO completa di filo e guaina di lunghezza 1500 mm.
BRAKING LEVER complete with wire and sheathing of 1500 mm length.
BREMSEN-HANDGRIFF mit Seil und Huelle, 1500 mm lang.
POIGNÉE DE FRENAGE complète de fil et gaine de 1500 mm de long.
LEVA PARA FRENO completa con hilo y vaina de 1500 mm de largo.

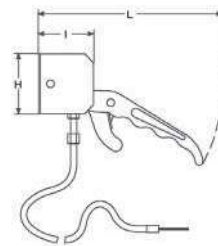

H	I	L	Art. N.
60	55	185	097

CAPPELLOTTI DI PROTEZIONE PROTECTION CAPS SCHUTZDECKELN COUPPELLES DE PROTECTION CAPSULAS DE PROTECCION

S	t	K	Art. N.
47	3	7,5	P2189
47	3	23,5	P2189/1

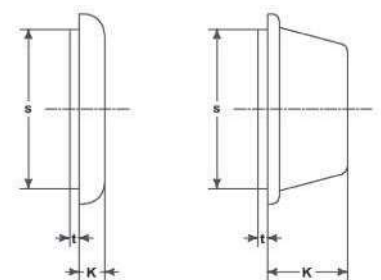

**RULLI PER TRANSPALLETTE - PALLET ROLLERS - GABELROLLEN
GALETS POUR TRANSPALETTE - RODILLOS PARA TRANSPALETAS**

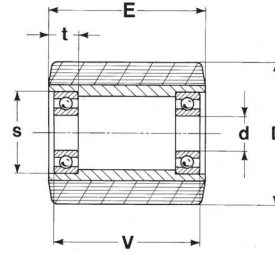

ACCIAIO + POLIURETANO COLATO STEEL + CAST POLYURETHANE STAHL + GUSS POLYURETHAN ACIER + POLYURETHANE COULE ACERO + POLIURETANO COLADO						
D x E	s x t	Art.	kg			V
70x70	35x11	1529cc	500	15x35x11	6202-Z	70
70x100	47x16	1503cc	650	20x47x14	6204-Z	96
75x62	47x14,2	1506cc	470	20x47x14	6204-Z	61,6
75x75	47x14	1741cc	570	20x47x14	6204-Z	75
75x76	40x14	1528cc	600	17x40x12	6203-Z	72
75x95	47x14	1513cc	720	20x47x14	6204-Z	95
78x78	47x16	1514cc	750	20x47x14	6204-Z	74
80x40	47x14	1762cc	400	20x47x14	6204-Z	40
80x50	47x14	1515cc	460	20x47x14	6204-Z	50
80x54	47x12	1519cc	500	25x47x12	6005-Z	54
	47x14	1520cc	500	20x47x14	6204-Z	54
80x60	47x14	1523cc	550	20x47x14	6204-Z	60
80x70	47x14	1533cc	700	20x47x14	6204-Z	70
80x80	47x14	1534cc	800	20x47x14	6204-Z	80
80x90	47x14	1535cc	900	20x47x14	6204-Z	90
82x51	52x15	1698cc	500	25x52x15	6205-Z	51
82x58	47x24	1727cc	580	20x47x14	6204-Z	38
82x60	47x14	1768cc	600	20x47x14	6204-Z	60
	47x16	1552cc	600	20x47x14	6204-Z	56
82x70	47x12	1680cc	700	25x47x12	6005-Z	70
	47x16	1749cc	700	17x47x14	6303-Z	66
	47x16	1537cc	700	20x47x14	6204-Z	66
82x75	42x24	1705cc	750	20x42x12	6004-Z	51
	47x14	1661cc	750	20x47x14	6204-Z	75
82x78	47x14	1697cc	780	20x47x14	6204-Z	78
	52x18	1713cc	780	25x52x15	6205-Z	72

ACCIAIO + POLIURETANO COLATO STEEL + CAST POLYURETHANE STAHL + GUSS POLYURETHAN ACIER + POLYURETHANE COULE ACERO + POLIURETANO COLADO						
D x E	s x t	Art.	kg			V
82x90	47x14	1708cc	900	20x47x14	6204-Z	90
82x100	47x12	1681cc	1000	25x47x12	6005-Z	100
	47x14	1722cc	1000	20x47x14	6204-Z	100
	47x16	1538cc	1000	20x47x14	6204-Z	96
85x40	47x14	1712cc	400	20x47x14	6204-Z	40
	47x14	1739cc	400	25x47x12	6005-Z	36
85x60	47x14	1683cc	600	20x47x14	6204-Z	60
	47x16	1674cc	600	20x47x14	6204-Z	56
85x70	47x14	1530cc	700	20x47x14	6204-Z	70
	47x17,5	1656cc	700	17x47x14	6303-Z	63
85x75	47x14	1703cc	750	17x47x14	6303-Z	75
	47x14	1594cc	750	20x47x14	6204-Z	75
	47x14	1742cc	750	25x47x12	6005-Z	71
85x78	47x14	1746cc	780	20x47x14	6204-Z	78
85x80	47x14	1532cc	800	20x47x14	6204-Z	80
	47x14	1700cc	800	25x47x12	6005-Z	76
85x90	47x14	1531cc	900	20x47x14	6204-Z	90
	47x14	1740cc	900	25x47x12	6005-Z	86
	47x17,5	1665cc	900	17x47x14	6303-Z	83
	47x17,5	1725cc	900	20x47x14	6204-Z	83
85x95	47x14	1668cc	950	20x47x14	6204-Z	95
	47x32	1565cc	950	20x47x14	6204-Z	59
	47x14	1536cc	1000	20x47x14	6204-Z	100
85x100	47x17,5	1673cc	1000	20x47x14	6204-Z	93
	47x17,5	1679cc	1050	17x47x14	6303-Z	103
85x110	47x32	1638cc	1050	20x47x14	6204-Z	74

RUOTE MOTRICI IN VULKOLLAN®
VULKOLLAN® DRIVE WHEELS
VULKOLLAN®-ANTRIEBSRÄDER
ROUES MOTRICES EN VULKOLLAN®
RUEDAS MOTRIZ EN VULKOLLAN®

(Desmodur 15 - Lic. Bayer) 93±3 Shore A

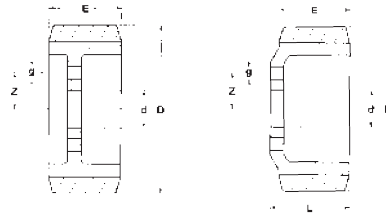

⊙	D	215	230	230	250	250	250	343	343	406
⊙	E/L	70/88	70/83	75	80	100	125	114	114	178/203
Art.	N.	327	341	343	368	372	374	394	395	399
	d	60	45	80	80	80	80	80	80	240
	g	5 Ø11	5 Ø13	6 Ø14	5 Ø15	5 Ø18,5	5 Ø18,5	5 Ø18,5	7 Ø18,5	12 Ø13
	Z	46	35	56	56	56	56	56	56	130
◆	Kg.	1230	1280	1400	1660	2020	2230	2785	2785	5300

RUOTE MOTRICI IN POLIURETANO
POLYURETHANE DRIVE WHEELS
POLYURETHAN-ANTRIEBSRÄDER
ROUES MOTRICES EN POLYURETHANE
RUEDAS MOTRIZ EN POLIURETANO

95±3 Shore A

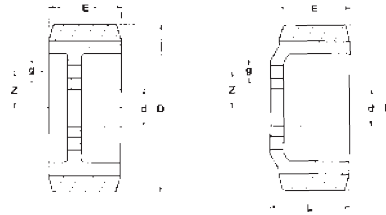

⊙	D	215	220	230	230	230	230	250	250
⊙	E/L	70/88	70/83	70/83	75/82	75	85/90	80	100
Art.	N.	527	533	541	542	543	547	568	572
	d	60	45	45	45	80	45	80	80
	g	5 Ø11	5 Ø13	5 Ø13	5 Ø13	6 Ø14	5 Ø12,5	5 Ø15	5 Ø18,5
	Z	46	35	35	35	56	35	56	56
◆	Kg.	1230	1270	1280	1400	1400	1480	1660	2020

ANELLI CILINDRICI IN VULKOLLAN®
VULKOLLAN® PRESS ON BANDS
ZILINDRISCHE VULKOLLAN®-BANDAGE
ANNEAUX CYLINDRIQUES EN VULKOLLAN®
ANILLOS CILINDRICOS EN VULKOLLAN®

(Desmodur 15 - Lic. Bayer) 93±3 Shore A

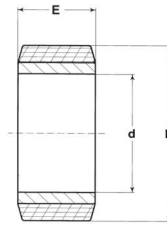

⊙	D	180	180	200	200	200	250	260	300	310	343	343	345	350	350	350
⊙	E	50	100	75	85	105	80	105	90	120	114	140	115	90	110	140
⊙	d	120	105	100	105	120	170	170	203	220	225	245	245	280	270	270
Art.	N.	223	241	218	220	226	240	242	248	202	254	203	259	205	265	204
◆	Kg.	720	1370	1040	1200	1570	1495	1965	1895	2680	2535	3115	2755	2440	2875	3660

ANELLI CILINDRICI IN POLIURETANO
POLYURETHANE PRESS ON BANDS
ZILINDRISCHE POLYURETHAN-BANDAGE
ANNEAUX CYLINDRIQUES EN POLYURETHANE
ANILLOS CILINDRICOS EN POLIURETANO

95±3 Shore A

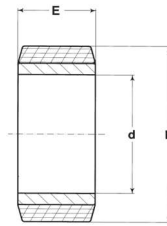

⊙	D	150	150	160	180	180	180	200	200	230	230	250	250	250	300	343
⊙	E	50	75	50	50	75	100	75	85	75	85	80	80	105	90	114
⊙	d	100	100	100	120	120	105	100	105	170	145	170	170	170	203	225
Art.	N.	145	161	162	150	151	141	153	146	156	155	160	165/S*	171	158	179
◆	Kg.	620	935	640	720	1080	1370	1040	1200	1380	1480	1495	1495	1960	1895	2535

SUPPORTI SENZA SBRACCIO

Supporti girevoli di tipo pesante senza sbraccio e con attacco per dispositivo sterzante. Disponibili solo per ruota Ø 200 mm. Freno per la sola ruota disponibile a richiesta.

FORKS WITHOUT OFF-SET

Heavy-duty swivel forks without offset suitable to be connected to a steering device. Available only for wheels Ø 200 mm. Wheel brake available on request.

GEHÄUSE OHNE AUSLADUNG

Lenkgehäuse in Schwerlast-Ausführung mit Verbindungszapfen zu einem Steuerungsgerät. Nur für Rad Ø 200 mm lieferbar. Rad-Feststeller lieferbar auf Anfrage.

CHAPES SANS DÉPORT

Chapes pivotantes type lourde sans déport et avec pivot de connexion à un dispositif de braquage. Disponible uniquement pour roue Ø 200 mm. Frein de la roue disponible sur demande.

SOPORTES SIN DESPLAZAMIENTO

Soportes giratorios tipo pesados sin despalzamiento y con enganche para dispositivo virador. Disponibles solo para ruedas Ø 200 mm. Freno para la sola rueda disponible sobre demanda.



BASTONI E TUBI IN POLIURETANO

POLYURETHANE RODS AND TUBES

BARREN UND ROHREN AUS POLYURETHAN

BÂTONS ET TUBES EN POLYURETHANE

BARRAS Y TUBOS EN POLIURETANO

90±3 Shore A



BASTONI - RODS - BARREN - BÂTONS - BARRAS

Ø D	mm	16	20	25	32	40	50	63	80	100	125
L	mm	250	250	250	500	500	500	500	500	500	500
Art.	N.	S521020	S521030	S521040	S521050	S521060	S521070	S521080	S521090	S521100	S521110



TUBI - TUBES - RÖHREN - TUBES - TUBOS

Ø D	mm	16	20	25	32	40	50	63	80	100	125
Ø d	mm	6,5	8,5	10,5	13,5	13,5	17	17	21	21	27
L	mm	250	250	250	500	500	500	500	500	500	500
Art.	N.	S521330	S521350	S521370	S521390	S521410	S521430	S521450	S521470	S521490	S521510

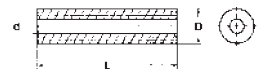

Tutti i diametri hanno tolleranze in meno - All diameters have tolerance with lower deviation - Alle Durchmesser haben Toleranz im unteren Abmass - Tous les diamètres ont tolérance en moins - Todos los diámetros tienen tolerancias en menos.